

## The fast-track dampproof system guaranteed for 30 years

The 'Original' damp-proof plastic membrane systems which eliminates dampness, the effects of salts and contaminated backgrounds. Guaranteed for 30 years. The surface of the membrane has a meshed key permanently manufactured to it, which provides a key for render,

plaster, or dab fixing plaster-board. The dimpled design creates an air gap, which insulates and allows for ventilation, and natural drying of the wall, while providing a dry decorative finish internally. The air gap can be vented externally via an air vent or internally using

the PT-profile strips at the top and bottom of the system.



Roll Size: 1.5m x 10m (15m<sup>2</sup>)

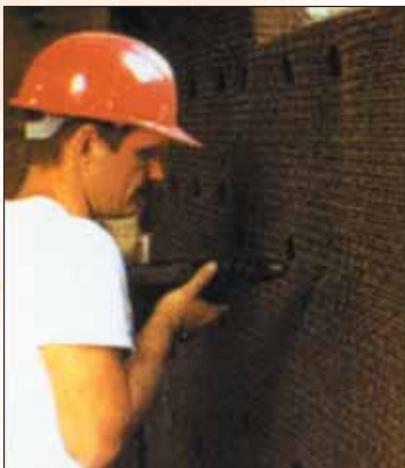

### Fixing

Fixing is by the special polypropylene Original-Lath plug at 250mm centres. An area 100mm free of mesh on the Original-Lath allows firm and positive overlap jointing.



### Dry Lining

Dry lining can be fixed to Original-Lath by applying plaster dabs directly onto Original-Lath fixings. (See manufacturer's instructions for full guide)



### Rendering

Original-Lath will accept traditional renders and plaster. All applications are applied in two coats. (See fixing instructions for full guide)

## Key Features

- Damp-proof system for walls
- Provides key for plaster, render or dab fix
- Fast-tack application
- Controls damp; salts and contaminated surfaces
- Air gap improves insulation
- East to use, easy to handle, just drill and fix

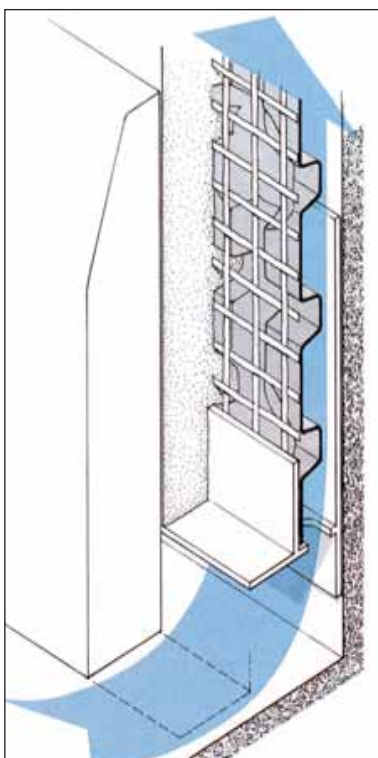
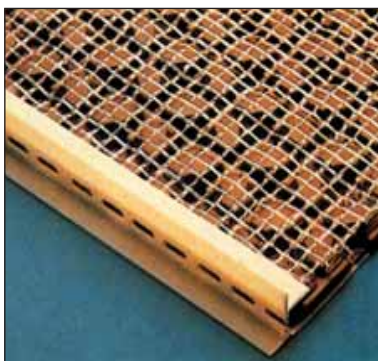
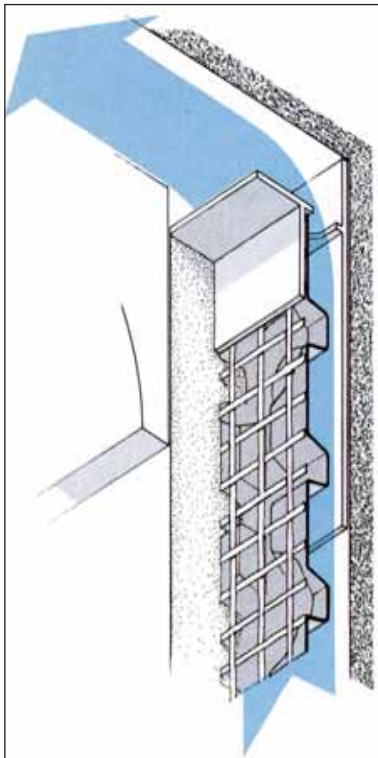

## Technical Data

<b>SIZE</b>	supplied in rolls 1.5m x 10m (15m <sup>2</sup> )
<b>WEIGHT</b>	8.5kg per roll
<b>DEPTH</b>	< 8mm
<b>RESISTANCE TO COMPRESSION</b>	80kN/m <sup>2</sup>
<b>TENSILE STRENGTH</b>	600N/60mm
<b>ELASTICITY</b>	60% (approx)
<b>TEMPERATURE RESISTANCE</b>	Thermal resistance for 105mm outer leaf at 2.7% v/V moisture content is: $0.105 = 0.072\text{mm}^2\text{K/W}$ 1.485
<b>STANDARD U-VALUES</b>	Original-Lath+ plaster+105mm brick wall 2.25W/m <sup>2</sup> K  Original-Lath+ Plaster+220mm brick wall 1.72W/m <sup>2</sup> K
<b>HEALTH &amp; SAFETY</b>	No health hazard

## Specification guide

<b>JOINTING</b>	Original-Lath to be lap jointed either horizontally or vertically allowing 100mm overlap.
<b>FIXING</b>	At 250mm internally and 150mm externally (maximum) Vertical and horizontal centres by Original-Lath Plugs, following manufacturer's instructions.
<b>PLASTERING*</b>	In accordance with BS5492
<b>RENDERING*</b>	In accordance with BS5262
<b>DECORATION</b>	Renderings to be thoroughly dry before Painting or application of wallpapers etc.

\* Refer to manufacturer's instructions for specific plasters and renders.

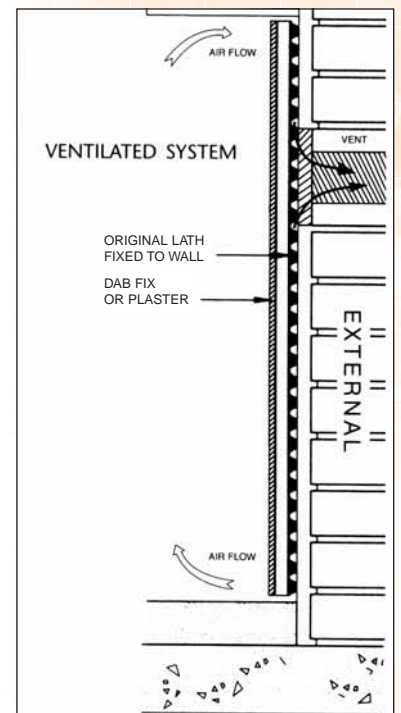
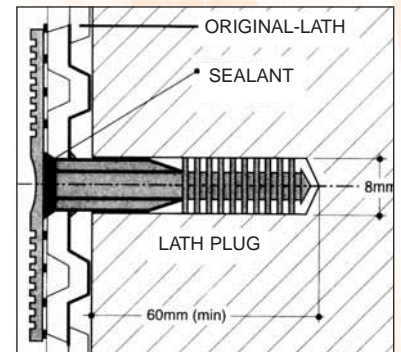
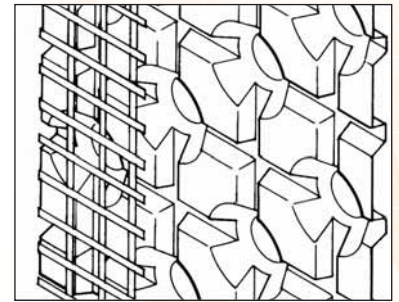

## Guarantee

Original-Lath is guaranteed against deterioration for a period of 30 years on condition that it has been fixed and finished in accordance with the manufacturer's instructions. Alderburgh Limited cannot be held responsible for the performance of plasters, renders or other finishes.

## NULIFE 500

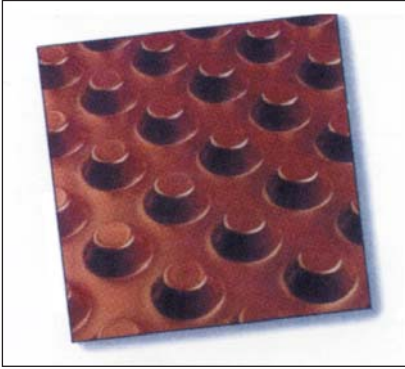

**Cavity drainage membrane for use on floors, as a waterproof system. A choice of finishes are available. Can also be used externally for waterproof protection of sub-ground structures.**

<b>Material:</b>	high density polyethylene
<b>Thickness:</b>	approx. 0.6 mm
<b>Stud height:</b>	approx. 8 mm
<b>Roll size:</b> (With flat edge of 7 cm on one side)	3.0 x 20 m 2.4 x 20 m 2.0 x 20 m (500 clear)
<b>Compressive strength:</b>	> 250 kN/m <sup>2</sup>
<b>Drainage capacity:</b>	approx. 2.25 l/s • m approx. 135 l/min • m approx. 8 100 l/h • m
<b>Air volume between studs:</b>	approx. 5.3 l/m <sup>2</sup>
<b>Temperature resistance:</b>	- 30°C to + 80°C
<b>Chemical properties:</b>	resistant to chemicals, resistant to root penetration, rotproof, neutral towards drinking water
<b>Behaviour in fire:</b>	B2 accord, to DIN 4102, in the case of special requirements possibly B1 accord. to DIN 4102 (test mark PA III 2.2087)

## NULIFE MS 20



**Dimpled sheeting with particularly high drainage capacity and compressive strength, suitable for high performance seepage layers in building and civil engineering construction.**

<b>Material:</b>	high density polyethylene
<b>Thickness:</b>	approx. 1 mm
<b>Stud height:</b>	approx. 20 mm
<b>Roll size:</b>	2.0 x 20 m In the case of special requirements, also available in board format approx.
<b>Compressive strength:</b>	150 kN/m <sup>2</sup>
<b>Drainage capacity:</b>	approx. 10 l/s • m approx. 600 l/min • m approx. 36 100 l/h • m
<b>Air volume between studs:</b>	approx. 14 l/m <sup>2</sup>
<b>Temperature resistance:</b>	- 30°C to + 80°C
<b>Chemical properties:</b>	resistant to chemicals, resistant to root penetration, rotproof, neutral towards drinking water
<b>Behaviour in fire:</b>	B2 accord, to DIN 4102, in the case of special requirements possibly B1 accord, to DIN 4102

All Alderburgh products are manufactured to the highest quality, being subject to rigid quality control. However, the company cannot control conditions of application and use of its products, thus any warranty, written or implied, is given in good faith for materials only.

Alderburgh Ltd will not accept any responsibility for damage or injury arising from storage handling, misapplication or misuse of its products. All transactions are subject to our standard condition of sale, copies of which are available on request.



### **Alderburgh Limited.**

Sladen Mill, Halifax Road, Littleborough, OL15 0LB.  
For Further Assistance Tel: 01706 374416, Fax: 01706 376785

E&OE. Without Guarantee.

email: sales@alderburgh.com